

What is IFX

- **Fasteners**
- **IFX Lite vs Full (*Free v Licensed*)**

Quick Demo



Contents

- Workings of IFX
- Setup Considerations
- Where to Edit
- Where to Store
- Resources
- OOTB Library



Default Configuration

- **Parts located in Creo Install point**
 - Common Files\afx\parts\

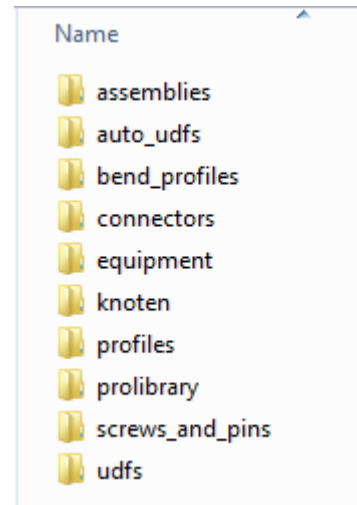

- **Configuration files**
 - User Interface
 - *.mnu*
 - Part Configuration Files
 - *.dat*
 - CAD Data
 - *Seed Part*



Determine Implementation Method

- **Add / Remove parts to 'Out of the Box' library**
 - Create parts based on copies of OOTB files
 - Modify OOTB items to include your Parameters
 - Add in-house Company parts to the UI
 - Remove OOTB choices from the menu
- **Start fresh with Legacy in-house Company Parts**
 - Naming for files
 - Create required datums & features
 - Designate datums and dimensions to the .dat file

Edit / Create CAD Files

- **File Naming**

- Key connection between UI and Data store
- MNU file points to DAT file
 - but must be referenced as a PRT

```
myfasteners.mnu *
My Legacy Fasteners
#
#
legacy_fasteners.prt
Converted Legacy Fasteners
Konvertiert ältere Befestigungen
```

- The *.mnu file name must be the same as the name of containing folder.
- The Screw, Nut, & Washer must be in commonly named folders

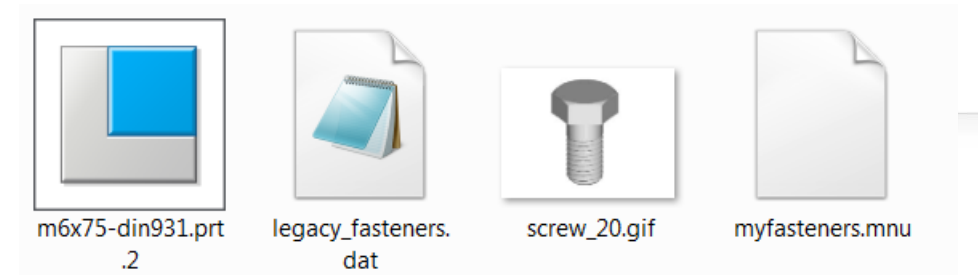
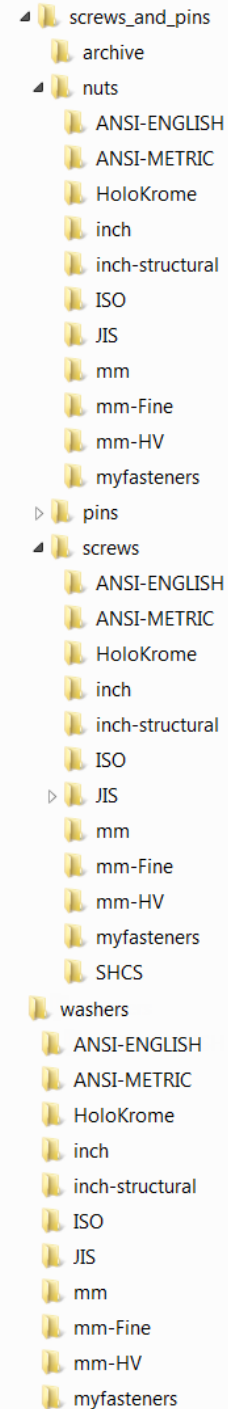

Creation Method of CAD Files for Library

- **On-The-Fly**
 - As defined in OOTB

- **Individual part files**
 - Pro
 - Revision of one part easier
 - Required when family parts are not allowed
 - Con
 - Revision of many parts difficult
 - Many more Parts in Windchill

- **Family Table**
 - Pro
 - Revision of many parts easy
 - Fewer files in Windchill
 - Easier creation of new variants
 - Con
 - More complicated to first create

- **TIP**
Use special DAT Syntax

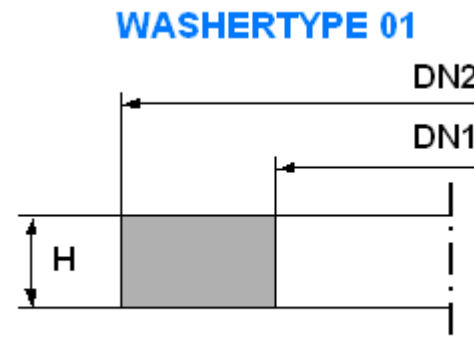

```

-----
!           Scheibe ohne Fase
!           Plain washer (without chamfer)
!           -----
WASHERTYPE      1
UNIT            MM
SURFACE        57
AXIS            80
CBSCR           DIN974-1 R5
CBNUT           DIN974-2 R1
INFO            my washer

FAMPRT          washer

SYMBOL          STRING  DN      H      DN1  DN2
INSTANCE        STRING  DN      H      DN1  DN2
#FAMTAB         M<DN>   d1     |d3   d1   d2
  
```

Edit UI

- IFX Migration Slide Deck

Posted on PTC IFX Community Site: <https://www.ptcusercommunity.com/docs/DOC-7126>

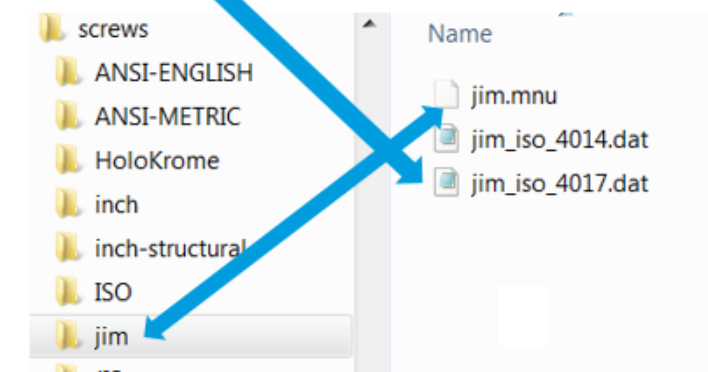
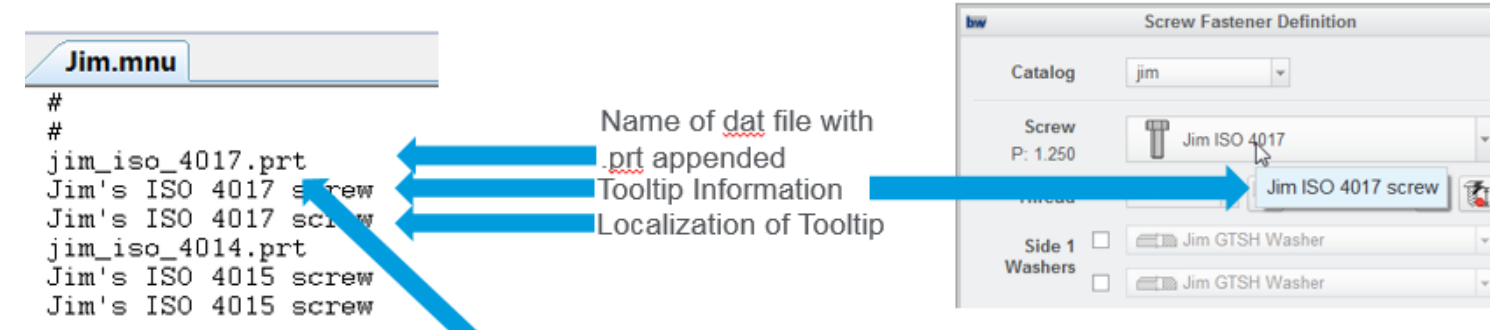
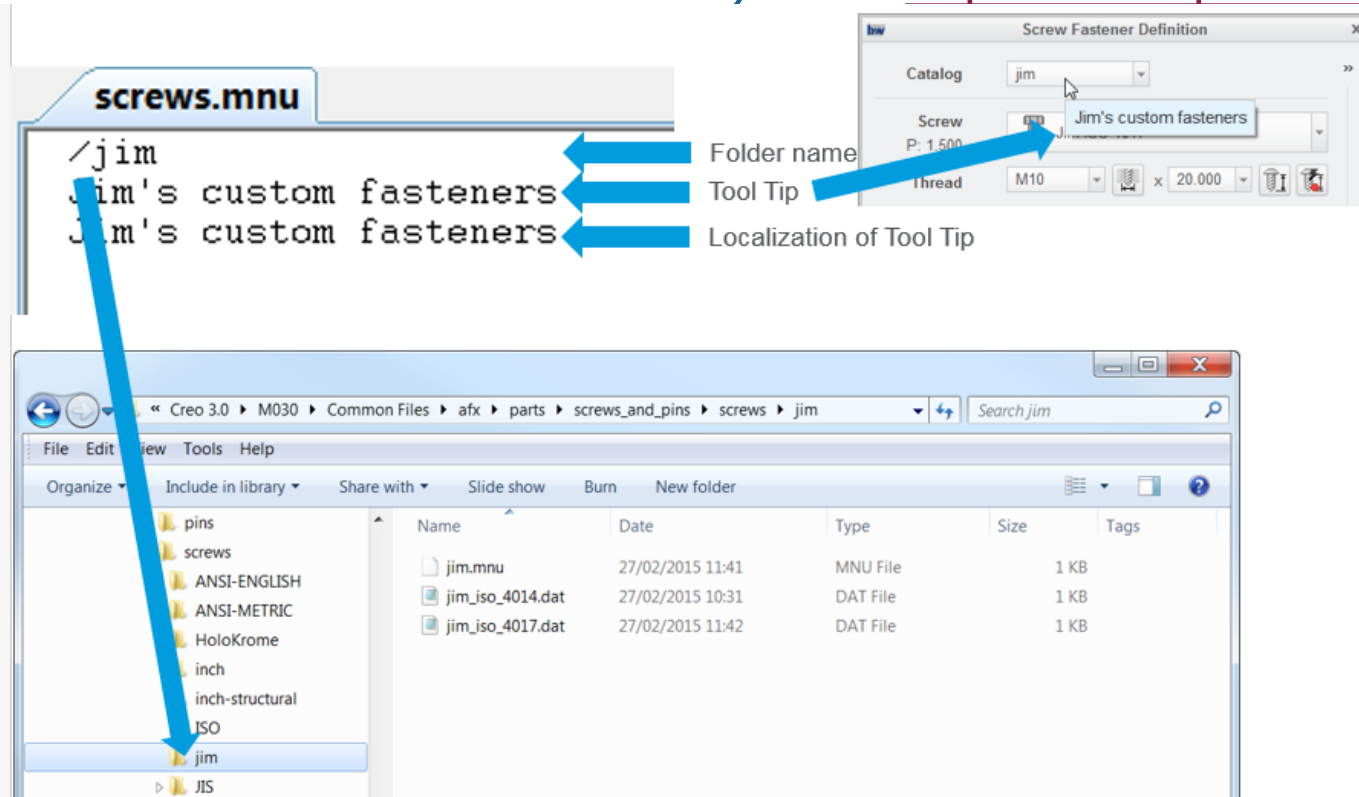

Edit Part DAT Files

- IFX Migration Slide Deck

Posted on PTC IFX Community Site: <https://www.ptcusercommunity.com/docs/DOC-7126>

jim_iso_4014.dat *

ISO 4014 - 8.8

Hexagon head screw with shank, product grades A and B
Sechskantschraube mit Schaft, Produktklassen A und B

SCREWTYPE 20
UNIT MM

SURFACE 495
AXIS 1440
CBSCR DIN974-2 R1
INFO Jim ISO 4014

SYMBOL INSTANCE STRING DN LG B S K DG P BUW_NAME

m6x70-din931	M6	6	70	18	10	4	5	1	hexhead
m6x75-din931	M6	6	75	18	10	4	5	1	hexhead
m6x80-din931	M6	6	80	18	10	4	5	1	hexhead

DIN974-2 R1
Jim ISO 4014

STRING DN LG B S K DG P BUW_NAME

in931	M6	6	70	18	10	4	5	1	hexh
in931	M6	6	75	18	10	4	5	1	hexh
in931	M6	6	80	18	10	4	5	1	hexh

2D - Preview

SYMBOL INSTANCE	STRING STRING	DN DN	LG LG	B B	S S	K K	DG DG	P P	BUW_NAME name
m6x70-din931	M6	6	70	18	10	4	5	1	hexhead
m6x75-din931	M6	6	75	18	10	4	5	1	hexhead
m6x80-din931	M6	6	80	18	10	4	5	1	hexhead

2D - Preview

Used for matching the nut. The pitch of the nut must match the pitch of the fastener

SCREWTYPE 20

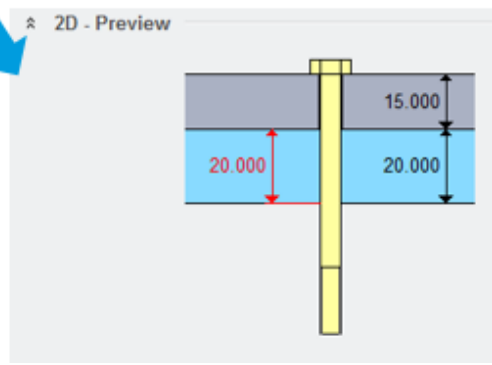
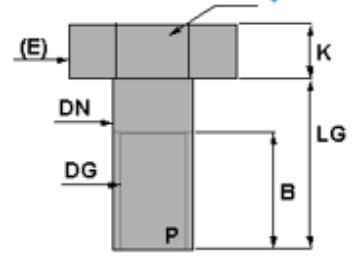

Putting DAT Files in Windchill

- **Store files in Installation point**

- *Current Method*
- *Use Current Structure*
- *Installation point must be updated when Windchill library is updated*

- **Store in PTC Windchill**

- *Planned Method - Direct integration to Windchill*
- *Use Structure Preferred by Org.*
- *Installation point will not need to change when content changes*

ETA Creo 3 Build M??? (Winter 2015)

Will be as Piping is currently implemented

Putting Files in Windchill

- **CAD Files**

- Can be stored in PTC Windchill Today
 - Dat and MNU files need to stay in the Installation
- Location
 - Upload to PTC Windchill in your preferred folder organization.
 - Needs to be accessible for all Users as Read Only

Team: Library - Fasteners

Members Local Team Roles and Members

Copy Paste Add Members Remove Expand Collapse Actions

Roles/Members	Description
Change Admin I	CAI
Change Admin II	CAII
Change Admin III	CAIII
Change Review Board	CRB
Collaboration Manager	Collaboration Manager role
Guest	This group grants read access to this library without requiring membership. This group is updated automatically based on library membership.
Library Manager	The group that plays the role: "Library Manager" for context: "Library - Fasteners".

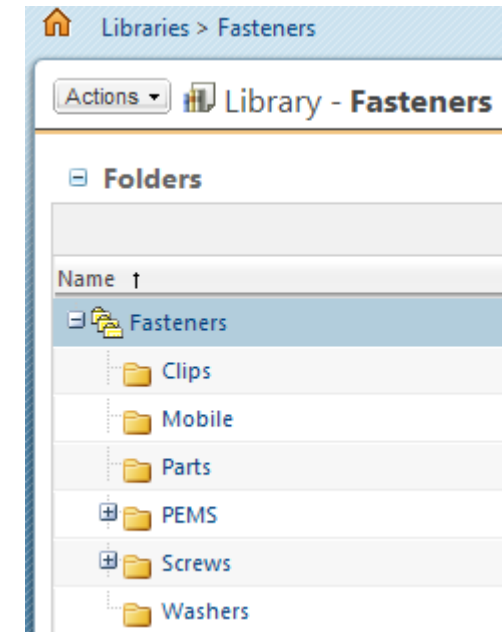

Putting Files in PTC Windchill

- **CAD Files**

- **Import Parts**

- **Individual Parts** (*OOTB Method*)

- **IFX Instance Creator**
- **See Video on PTC IFX Community**

- **Family Table**

- **Edit Dimension Names**
- **Create Family Table**
- **Use DAT file information**
- **Draft document available for email.**
Final will be published to M060 Help Center

```
!-----!  
!           Scheibe ohne Fase  
!           Plain washer (without chamfer)  
!-----!  
  
WASHERTYPE      1  
UNIT            MM  
SURFACE        57  
AXIS           80  
CBSCR          DIN974-1 R5  
CBNUT          DIN974-2 R1  
INFO           my washer  
  
FAMPRT washer  
  
SYMBOL          STRING DN   H   DN1  DN2  
INSTANCE        STRING DN   H   DN1  DN2  
#FAMTAB         M<DN>  d1  |d3  d1   d2
```

TEST!



Where to find Detailed Information

- **Learning Exchange**

- http://learningexchange.ptc.com/tutorials/search?product_id=1&search=fastener

- **Help Center**

- http://help.ptc.com/creo_hc/creo30_pma_hc/usascii/index.html#page/pma/assembly/About_Working_with_Intelligent_Fastener.html

- **Tutorial**

- Introduction to IFX
 - http://help.ptc.com/creo_hc/creo30_pma_hc/usascii/index.html#page/pma/tutorials_pma/ifx_tutorials_overview.html
- Customization
 - Coming Summer 2015 -- M050

- **Community**

- <https://www.ptcusercommunity.com/groups/intelligent-fastener-extension-ifx-by-bw-software>

Questions



Please use PTC Community to post questions

We will be monitoring the group and replying

<https://www.ptcusercommunity.com/groups/intelligent-fastener-extension-ifx-by-bw-software>

- Your feedback is valuable
- Don't miss out on the chance to provide your feedback
- Gain a chance to win an instant prize!
- Complete your session evaluation now

Reference Materials

Out of the Box Library Contents

MM

HEX Head With Shank	HEX Head Full Thread	HEX Socket Head Cap	Hexalobular Socket Head	HEX Socket Button Head	HEX Socket Countersunk	Hexalobular Countersunk	Slotted Cheese Head	Slotted Flat Countersunk	Slotted Pan Head	Pan Head with Cross Recess	Lifting Eye
ISO 4014 - 5.6	ISO 4017 - 5.6	ISO 4762 - 8.8	ISO 14579 - 8.8	ISO 7380-1 - 8.8	ISO 10642 - 8.8	ISO 14581 - 4.8	ISO 1207 - 4.8	ISO 2009 - 4.8	DIN 921 - 5.8	ISO 7045 - 4.8	DIN 580 - c15
ISO 4014 - 8.8	ISO 4017 - 8.8	ISO 4762 - 10.9	ISO 14579 - 9.8	ISO 7380-1 - 10.9	ISO 10642 - 10.9	ISO 14581 - 8.8	ISO 1207 - 5.8	ISO 2009 - 5.8			
ISO 4014 - 10.9	ISO 4017 - 10.9	ISO 4762 - 12.9	ISO 14579 - 10.9	ISO 7380-1 - 12.9	ISO 10642 - 12.9	ISO 14582 - 4.8	ISO 1580 - 4.8	DIN 963 - 4.8			
ISO 4016 - 4.6	ISO 4018 - 4.6	DIN 7984 - 8.8	ISO 14579 - 12.9	ISO 7380-2 - 8.8	DIN 7991 - 8.8	ISO 14582 - 8.8	DIN 84 - 4.8	DIN 963 - 5.8			
ISO 4016 - 4.8	ISO 4018 - 4.8	DIN 6912 - 8.8	ISO 14580 - 4.8	ISO 7380-2 - 10.9	DIN 7991 - 10.9	ISO 14582 - 10.9	DIN 85 - 4.8				
ISO 8765 - 5.6	ISO 8676 - 5.6	DIN 912 - 8.8	ISO 14580 - 5.8		DIN 7991 - 12.9						
ISO 8765 - 8.8	ISO 8676 - 8.8	DIN 912 - 10.9									
ISO 8765 - 10.9	ISO 8676 - 10.9	DIN 912 - 12.9									
DIN 7990 - 4.6	DIN 961 - 5.6										
DIN 960 - 5.6	DIN 961 - 8.8										
DIN 960 - 8.8	DIN 961 - 10.9										
DIN 960 - 10.9											

Chamfered	Plain	Square Taper	Specific Bolt Type	Spring Lock	Nord Lock	Plain	Prevailing	With Flare	Dome
DIN EN ISO 7090	DIN EN ISO 7092	DIN 434 U	DIN433-2	DIN 7980	Nord-Lock	ISO 4032 - 6	DIN 6915 - 10	ISO 7040 - 5	DIN EN 1661 - 8
DIN 125-1-B	DIN EN ISO 7091	DIN 435 I	DIN 125-2-A	DIN 127-A	Nord-Lock ss	ISO 4032 - 8	DIN 934 - 6	ISO 7040 - 8	DIN EN 1661 - 10
DIN 125-2-B	ISO 7093-1	DIN 6917 I - HV		DIN 127-B	Nord-Lock ss-254	ISO 4032 - 10	DIN 934 - 8	ISO 7040 - 10	DIN EN 1661 - 12
DIN 6916 (HV)	DIN 7989 - A	DIN 6918 U - HV		DIN 128-A		ISO 4033 - 9	DIN 934 - 10	ISO 10511 - 5	DIN 6923 - 8
	DIN 433-1					ISO 4033 - 10	DIN 555	ISO 10511 - 8	DIN 6923 - 10
	DIN 125-1-A					ISO 4033 - 12	DIN 555	ISO 10511 - 10	DIN 6923 - 12
						ISO 4035 - 04	DIN 439 - 04	DIN 982 - 5	
						ISO 4035 - 05	DIN 439 - 05	DIN 982 - 8	
								DIN 982 - 10	

MM-HV

Hex

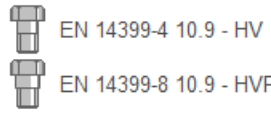

Chamfered



Plain



Square Taper



Plain



MM Fine

HEX Head With HEX Head Full Shank Thread

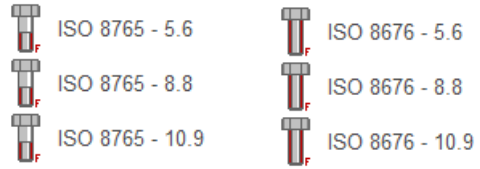

Chamfered

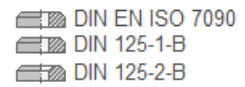

Plain



Square Taper



Specific Bolt Type

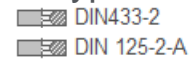

Spring Lock

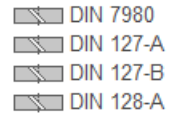

Nord Lock

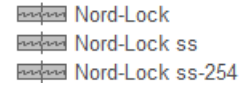

Plain



Prevailing



Dome



Inch

HEX Head With Shank



Hex Bolt



Heavy Hex Bolt

HEX Socket Head Cap



Hex.Socket Head Cap Screw

Countersunk



Countersunk Screw

HEX Cap



Hex Cap Screw

Heavy Hex



Heavy Hex Screw

Plain

Type A Plain Washer (narrow)

Type A Plain Washer (wide)

Spring Lock

Spring Lock Washer (regular)

Spring Lock Washer (heavy)

Nord Lock

Nord-Lock

Nord-Lock ss

Nord-Lock ss-254

Plain

HexNut

HexJamNut

Non Locking

PEM-AC-2

PEM-AS-2

PEM-LAC-2

PEM-LAS-2

Inch Structural

Heavy Hex

 Heavy Hex Structural Bolt - A490, Type 1

 Heavy Hex Structural Bolt - A325, Type 1

Plain

 Hardened Steel Circular Washer - F436

Square Taper

 Square Beveled Washer - F436

Plain

 Heavy Hex Nut - A563, Grade DH

 Heavy Hex Nut - A563, Grade C

PTC[®] Live Global